

3/17

1

5

110  
AV.  
E.



00-00737

Hosoo-01238

Tacoma-Pierce County Health Department

# ON-SITE SEWAGE DISPOSAL SYSTEM AS-BUILT # 5012

Environmental Health



SITE ADDRESS 15424 110TH AVE. E.

Previous Address \_\_\_\_\_

City/State/Zip Puyallup, WA. 98154

Redesign/Finished  As-Built  YES Community System YES

## PLEASE PRINT

Parcel Number 041922-0-011 Subdivision N/A Lot # N/A Permit # 01234

Owner/Applicant BOB LINGBERG Phone # 848-7091

Address 15424 110TH AVE. E. City/State/Zip Puyallup, WA. 98154

Designer LOUIE / PAUL E GREEN # 1813 Phone # 848-6608

Address Rt 304 746 City/State/Zip Puyallup, WA. 98154

Installation Firm DMANOR SEPTIC # 424 Phone # 847-3250

Address P.O. Box 1271 City/State/Zip GRANHAM, WA. 98148

I hereby certify that the accompanying drawing substantially depicts the on-site sewage disposal system installed at the above-referenced address. I inspected the on-site sewage disposal system prior to backfill and final cover and determined that it appeared to comply with all requirements and restrictions of the approved on-site sewage system design.

Signature of Designer \_\_\_\_\_ Date 03-31-00

### - FOR HEALTH DEPARTMENT USE ONLY -

ACCEPTED DATE 9/1/00 EHS Signature Carol McDaniel

Hold Date \_\_\_\_\_ EHS Signature \_\_\_\_\_

Comments: \_\_\_\_\_

04M # 200003270354

Hold Date \_\_\_\_\_ EHS Signature \_\_\_\_\_

Comments: \_\_\_\_\_

As-built accepted in lieu of final inspection

Date/Initials \_\_\_\_\_

Final Inspection 3/30/00 CM  
Date/Initials

HOLD for

Backfill Verification

ONLY

4/7/00 CM  
Date/Initials 9-1-00 CM

Please ATTACH 4 (four) SEPARATE AS-BUILT DRAWINGS

RECEIVED

3629 South D ST MS:009 Tacoma WA 98408-6897 (253) 798-6470 FAX (253) 798-7663

HEA 000 (Rev. 06/96) WRITE-FILE YELLOW-DESIGNER/INSTALLER

PINK-APPLICANT

APR 03 2000

CC: 4-10-00 Tacoma-Pierce County Health Department

9-1-00 CM



110TH AVENUE EAST

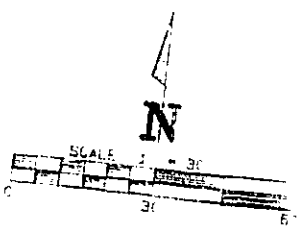

**INSTALLATION SPECIFICATIONS**

- 1000 G.P. SEWER TANK INSTALL
- 100 G.P. HUM. TANK INSTALL
- 250 G.P. OF DRAINFIELD INSTALL
- N/A BED INSTALLED
- N/A 100 G.P. CAPACITY TANK SYSTEM
- 1/4" DRAINAGE
- 1/2" TRANSDUCER PIPE INSTALL

**RECEIVED**  
**APR 03 2000**  
Tacoma-Pierce County  
Health Department

AS BUILT



Site Address 15424 110TH AVE E

Parcel No. 041922-3-014

Subdivision N/A

Project AMASUR SERVICE LOT N/A

Client BOB LUNGBERG

Engineer PAUL GREEN

PE22420 No. 163

**LEROY SURVEYORS & ENGINEERS, INC.**

P.O. 807 740  
MUYALLUP, WASHINGTON 98372  
(206) 848-6608 FAX (206) 840-3140

Date 4 15 00 Scale 1"=30' Drawn By: PDH Job No. 5612

RETAKE OF  
PREVIOUS  
DOCUMENT

15424 110<sup>th</sup> AVE ①

Tacoma-Fierce County  
Health Department  
ACCEPTED AS-BUILT

SEP 01 2000

*Carol McDevitt*  
Sanitarian

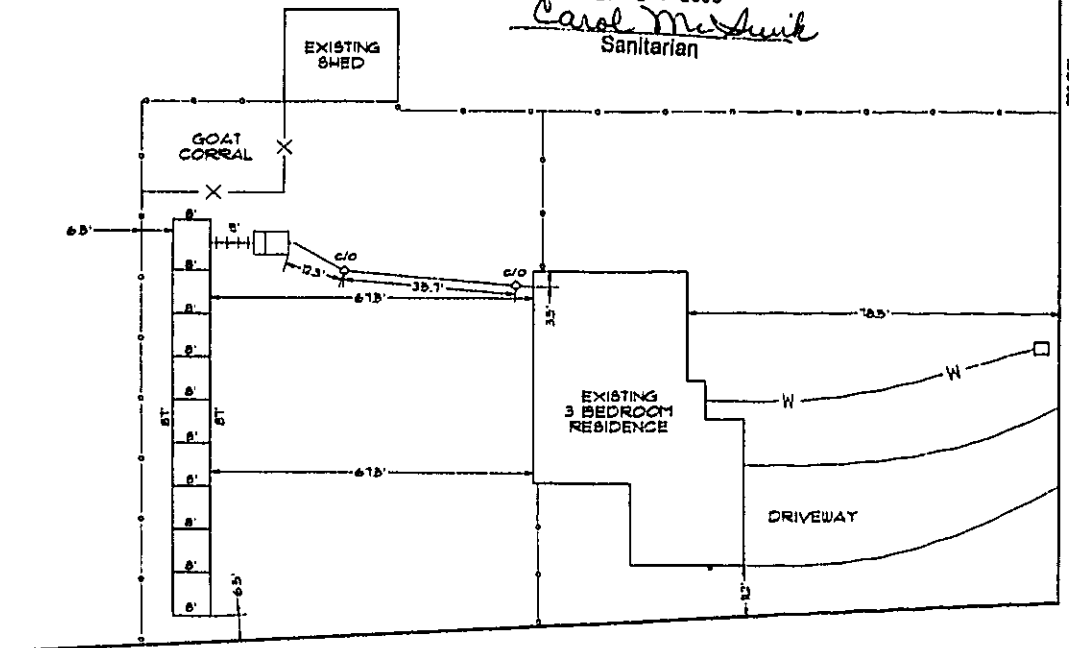

110TH AVENUE EAST

2

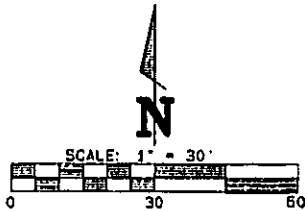

**INSTALLATION SPECIFICATIONS**

- ~~1000~~ GAL. SEPTIC TANK INSTALLED.
- ~~N/A~~ GAL. PUMP TANK INSTALLED.
- ~~250~~ LF OF DRAINFIELD INSTALLED.
- ~~N/A~~ BED INSTALLED.
- ~~N/A~~ GAL. CAPACITY FAST SYSTEM.
- ~~(2) 4"~~ CLEANOUT.
- ~~9 LF~~ OF TRANSPORT PIPE INSTALLED.

**RECEIVED**

**APR 03 2000**

Tacoma-Pierce County  
Health Department

**AS-BUILT**



EXPIRES: 4-22-2001

|   |               |                            |
|---|---------------|----------------------------|
| Site Address: 15424 110TH AVE. E.   |               | 1<br>2                     |
| Parcel No. 041922-3-014   |               |                            |
| Subdivision: N/A  | Lot N/A       |                            |
| Installer: AMASTER SEPTIC   |               |                            |
| Client: BOB LUNGBERG  |               |                            |
| Engineer: PAUL GREEN  | PE22420       | No. 183                    |
| <b>LeROY SURVEYORS &amp; ENGINEERS, INC.</b>                                    |               |                            |
| P.O. BOX 740<br>PUYALLUP, WASHINGTON 98372<br>(206) 848-6608 FAX (206) 840-4140 |               |                            |
| Date: 3-15-00   | Scale: 1"=30' | Drawn By: PDH Job No. 5612 |

3

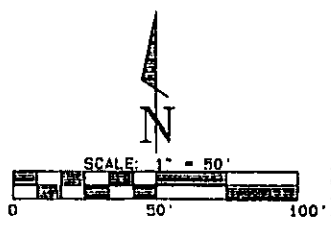
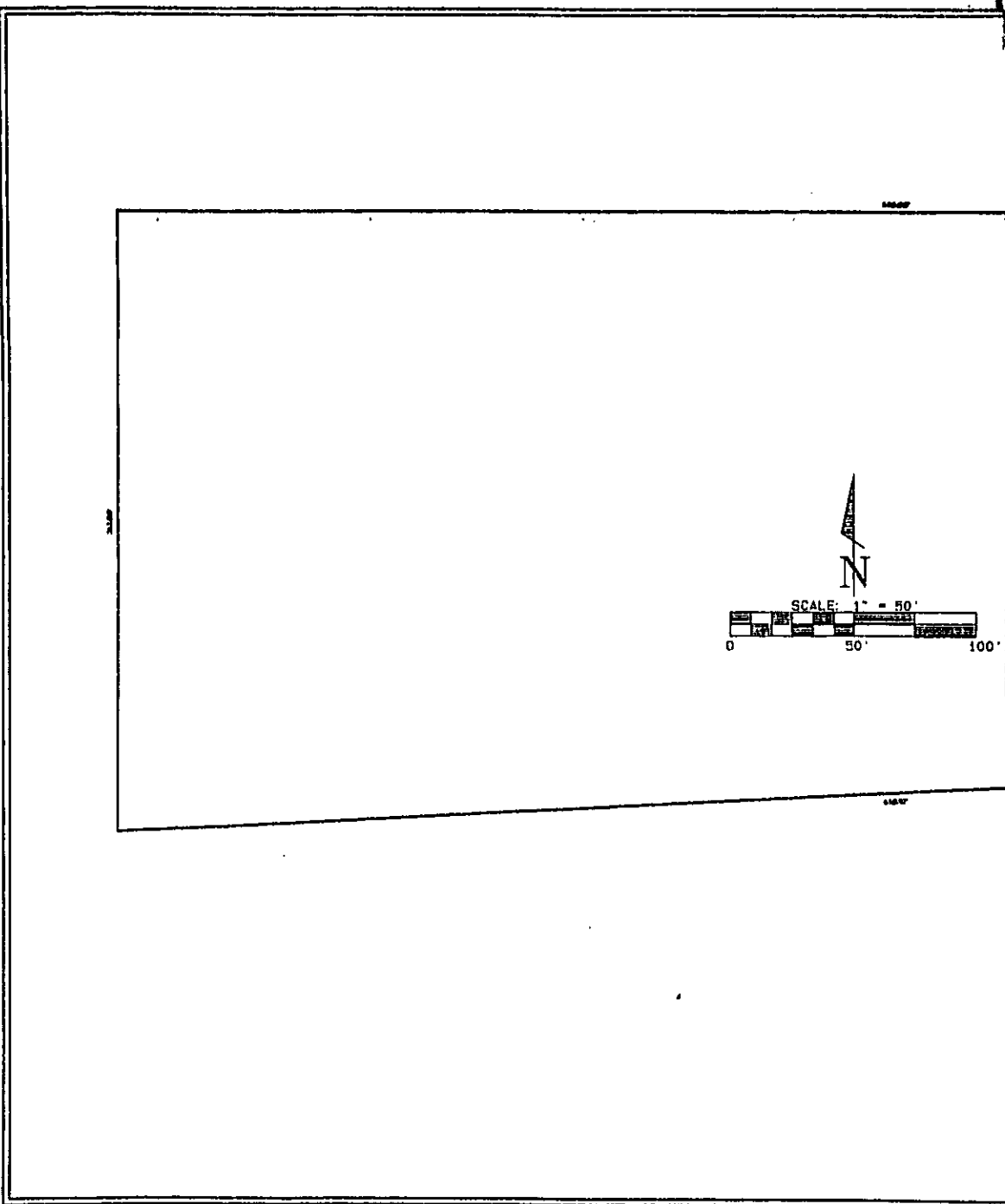



4

Tacoma-Pierce County  
Health Department  
ACCEPTED AS-BUILT

SEP 01 2000

*Carol M. Smith*  
Sanitarian

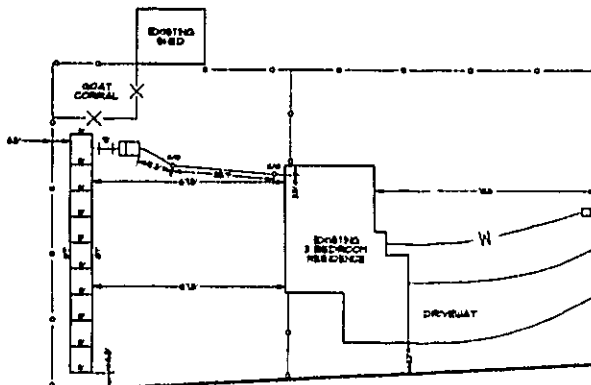

110TH AVENUE EAST

RECEIVED

APR 03 2000

Tacoma-Pierce County  
Health Department

AS-BUILT



EXPIRES: 4-22-2001

|   |               |                            |
|---|---------------|----------------------------|
| Site Address: 15424 110TH AVE. E.   |               | 2                          |
| Parcel No: 041922-3-014   |               | 2                          |
| Subdivision: N/A  | Lot N/A       |                            |
| Installer: AMASTER SEPTIC SERVICE   |               |                            |
| Client: BOB LUNGBERG  |               |                            |
| Engineer: PAUL GREEN  | PE22420       | No. 183                    |
| LeROY SURVEYORS & ENGINEERS, INC.   |               |                            |
| P.O. BOX 740<br>PUYALLUP, WASHINGTON 98372<br>(206) 848-6608 FAX (206) 840-4140 |               |                            |
| Date: 3-15-00   | Scale: 1"=50' | Drawn By: PDH Job No: 5612 |

8-00737



# SEWAGE SYSTEM INSTALLATION PERMIT

Expiration Date: 03/24/2001  
Permit #: HOS00-01238

NC

Site Address: 15424 110TH AV E

Parcel #: 0419223014

Subdivision:

Lot & Block: L B

Pierce County Building Permit #: \_\_\_\_\_

Installation Firm: **AMASTER SEPTIC SERVICE, INC**  
PO BOX 1231  
GRAHAM, WA 98338-1231

RECEIVED

APR 03 2000

Tacoma-Pierce County  
Health Department

All work must be performed in accordance with current laws, ordinances, resolutions, and rules and regulations.  
SYSTEM IS NOT APPROVED FOR USE UNTIL AN ASBUILT IS SUBMITTED AND ACCEPTED.

**DESIGNER**  
GREEN, P.E. PAUL E  
1103 SHAW ROAD  
PUYALLUP, WA 98372

**OWNER/APPLICANT**  
LUNGBERG BOB  
15424 110TH AV E  
PUYALLUP, WA 98374

Date Accepted 3-29-00

Date O.K. to Cover \_\_\_\_\_

Date Disapproved \_\_\_\_\_

Date Disapproved \_\_\_\_\_

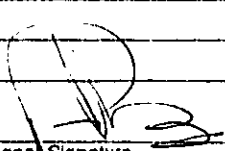
  
X \_\_\_\_\_ FOR P. GREEN

X \_\_\_\_\_  
Sanitarian Signature

Designer Signature  
O.K. to cover 3 working days after accepted date unless otherwise indicated by the Sanitarian.

I have complied with all restrictions and requirements as listed and designed by the Certified Sewage Disposal System Designer as indicated on the approved plan (or latest revision thereof), and have complied with the Tacoma-Pierce County Codes on Sewage Disposal System Installation

Please Print Installer Name  
ngm  
Installer Signature

Installer Certificate Number  
3-26-00  
Date of Installation

TO BE POSTED ON SITE - DO NOT ALTER OR DEFACE

FROM : AMASTER INC

FAX NO. : 2538473372

AUG. 25 2000 12:10PM P1

✓  
0-00737

TACOMA-PIERCE COUNTY HEALTH DEPARTMENT

INSTALLER BACKFILL NOTIFICATION / VERIFICATION

(PLEASE PRINT)

SITE ADDRESS: 15424 110th Ave E

CITY: \_\_\_\_\_

INSTALLATION PERMIT NUMBER: H0500-d238 BUILDING PERMIT NUMBER: \_\_\_\_\_ (Optional)

OWNER: Bob Lungberg

ADDRESS: \_\_\_\_\_

DESIGNER: LEROY # \_\_\_\_\_ (Please Print)

INSTALLER: AMASTER # 424 (Please Print)

Employed by: AMASTER # 424 (Name of Installation Firm)

1. Dennis K Horak # 866 (SIGNATURE of Installer)

(Check one)

- was present at this site during backfill and cover
- supervised/delegated placement of backfill and cover

on the date indicated and certify compliance with all requirements regarding backfill and grade of system, (WAC 246-272).

DATE BACKFILLED 8-25-00 (Placement of final cover)

Instructions:

**CERTIFIED INSTALLER:**

- 1) You must place, be physically present or delegate supervision for placement of final cover material on the sewage disposal system;
- 2) This form shall be used to certify that you have placed or supervised/delegated final cover placement
- 3) Send via: 1) FAX - (206) 591-7663, OR  
2) MAIL - 3629 South D St -MS:009 Tacoma, WA 98408-6897, OR  
3) TO DESIGNER to be included in as-built package submittal

**CERTIFIED DESIGNER/P.E./R.S.:**

- 1) This completed form MUST be included with the as-built package submittal if received from the installer

NOTE: COVER VERIFICATION IS REQUIRED FOR ACCEPTANCE OF AS BUILT

RECEIVED  
AUG 25 2000  
TPCHD.

FINAL INSPECTION

DATE: 3/24/00  
SITE: 15414 RD. W. - 8  
APP: Asphalt  
CALLER: City of  
DESIGNER: City of  
INSTALLER: Smith  
Comments: NOV 15 2000

- Final OK, Hold for Asbuilt
- Accept Asbuilt in Lieu of Final
- Red-Tagged

date: 3/30/00 Init: OMC



# REPAIR

## REPAIR FOR ON-SITE SEWAGE PROGRAM



119-4611 RMA

TROND  
3629 SOUTH ST. AVE. COOP  
TACOMA WA 98409  
03/17/2000 3:40 PM  
SEPT: 9630 4-0  
CHECK #12413

Street: 15424 110TH AVE E 183  
 City: PLYMOUTH St: WA Zip: 98374

Street: \_\_\_\_\_  
 City: \_\_\_\_\_ St: \_\_\_\_\_ Zip: \_\_\_\_\_

Last: LUNGBERG First: BOB 848-7091

This Application expires one year from date of approval.

Applicant Address: 15424 110TH AVE. E. City: PLYMOUTH St: WA Zip: 98374  
 Section: 02 Township: 19 Range: 04 Field Area: \_\_\_\_\_ Parcel#: 011922-3-014  
 Subdivision Name: N/A Lot: N/A Block: \_\_\_\_\_  
 Water Supply: P (I/P)-Individual P-Public Class: \_\_\_\_\_  
 Public Water Supply Name: KIRARONE ID#: 25160M  
 Property Size: 164,150 SQ. Ft. Within ULID: N (Y/N)  
 Flood Zone: N (Y/N) Basin 12: N (Y/N)  
 Shellfish Sensitive Area: N (Y/N) If yes, specify area: \_\_\_\_\_ (B/F/M/R/O) (B-Burley Lagoon F-Fulcy Bay M-Minter Bay R-Rocky Bay O-Other)  
 Type of Building: SF (SF/MF/COMM/FE/INST) Number of Units: \_\_\_\_\_  
 SF-Single Family MF-Multi-Family COMM-Commercial FE-Food Establishment INST-Institutional  
 Garbage Disposal Proposed: N (Y/N) Proposed Number of Bedrooms: 3  
 Initial installation date, if known: UNKNOWN  
 If system has been repaired before, Please indicate Number of repairs: 0  
 Plot plan attached? Y  
 Soil logs attached? Y  
 Minimum trench depth: 18" Maximum trench depth: 24  
 Designer's Signature (if applicable): \_\_\_\_\_

RECEIVED  
MAR 17 2000  
Tacoma-Pierce County Health Department

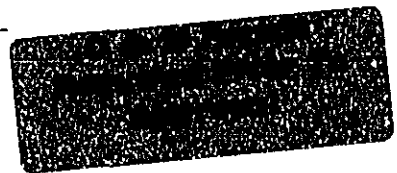

### FOR HEALTH DEPARTMENT USE ONLY

Water Supply:  approved ULID: \_\_\_\_\_ ok for on-site  
\_\_\_\_\_ hold for sewer  
 By: MS Date: 3/21/00 By: \_\_\_\_\_ Date: \_\_\_\_\_

- Circle Possible reasons for failure: (multiple entries ok)
- 1) Poor soil quality
  - 2) High seasonal water table
  - 3) Inadequate drainfield
  - 4) Lack of grease trap
  - 5) Inadequate or lack of pumping septic tank
  - 6) Excessive water usage
  - 7) Physical damage to system
  - 8) Unable to determine
  - 9) Other

Comments: TILE D.P.F. IS CLOGGED / CONC. BOFFLES  
DETERIORATED ALLOWING SOLIDS INTO P.F.

| FOR OFFICE USE ONLY  | DATE       | INIT      |
|----------------------|------------|-----------|
| SUBMITTAL            |            |           |
| HOLD                 |            |           |
| APPROVAL/DISAPPROVAL |            |           |
| MAILED/TO-BOX        | <u>3/1</u> | <u>MS</u> |

APPROVED: 3-21-00 (date) BY: [Signature] E.H.S.  
 HOLD: 3-21-00 (date) REASON: RRP BY: [Signature] E.H.S.  
 DISAPPROVED: \_\_\_\_\_ (date) REASON: \_\_\_\_\_ BY: \_\_\_\_\_ E.H.S.



2

110

110TH AVENUE EAST

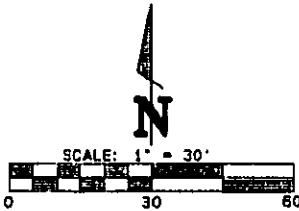

**LEGEND**

- ▲ SOIL LOGS
  - BENCH MARK
  - \*\*\*\* STEP DOWN
  - ++++ 2" OR 4" DIA. PVC PIPE TIGHTLINE
  - 3" DIA. DWV OR 4" DIA. PVC CLEANOUT
  - ==== 1 1/4" OR 4" DIA. PVC PERF PIPE
  - W— WATER LINE
  - ◉ 1,000 GALLONS PUMP CHAMBER (IF APPLICABLE)
  - DISTRIBUTION BOX (IF APPLICABLE)
  - ▭ 1,000 GALLONS (2 COMP.) SEPTIC TANK
- IN CASE THE STUB-OUT ELEVATION IS LOWER THAN SEPTIC TANK INLET ELEVATION, A HYDROMATIC PUMP OSP 33 OR APPROVED EQUAL, PUMP CHAMBER AND DISTRIBUTION BOX WILL BE INSTALLED.

SL 1  
 0-4 TOPSOIL  
 4-24 LOAMY SAND  
 24-60 CLEAN FINE TO MED. SAND

RECEIVED  
 MAR 17 2000  
 Tacoma-Pierce County  
 Health Department

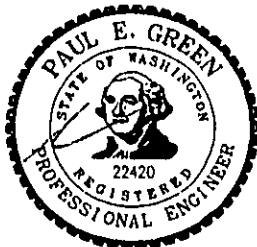

EXPIRES: 4-22-2001

|   |               |               |
|---|---------------|---------------|
| Site Address: 15424 110TH AVE. E.   |               | 1             |
| Parcel No. 041922-3-014   |               | 3             |
| Subdivision: N/A  | Lot N/A       |               |
| <b>On-Site Sewage Disposal System</b>   |               |               |
| Client: BOB LUNGBERG  |               |               |
| Engineer: PAUL GREEN  | PE22420       | No. 183       |
| <b>LeROY SURVEYORS &amp; ENGINEERS, INC.</b>                                    |               |               |
| P.O. BOX 740<br>PUYALLUP, WASHINGTON 98372<br>(206) 848-6608 FAX (206) 840-4140 |               |               |
| Date: 3-15-00   | Scale: 1"=30' | Drawn By: PDH |
|   |               | JOB No. 5612  |



3

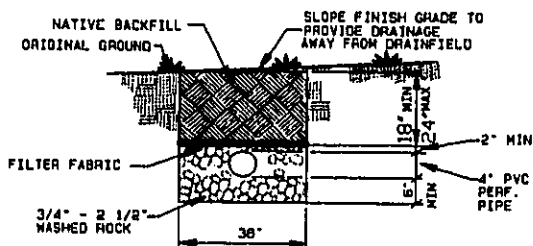

**CONVENTIONAL SYSTEM  
TRENCH DETAIL**  
NOT TO SCALE

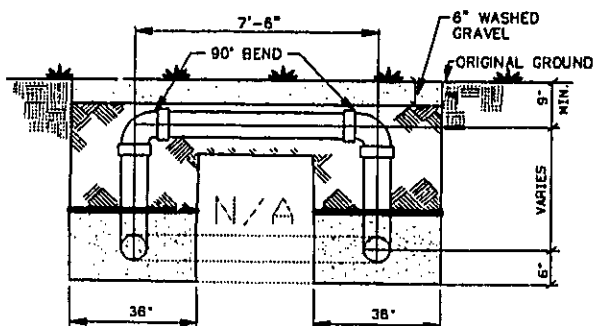

**VENT PIPE, DETAIL**  
NOT TO SCALE

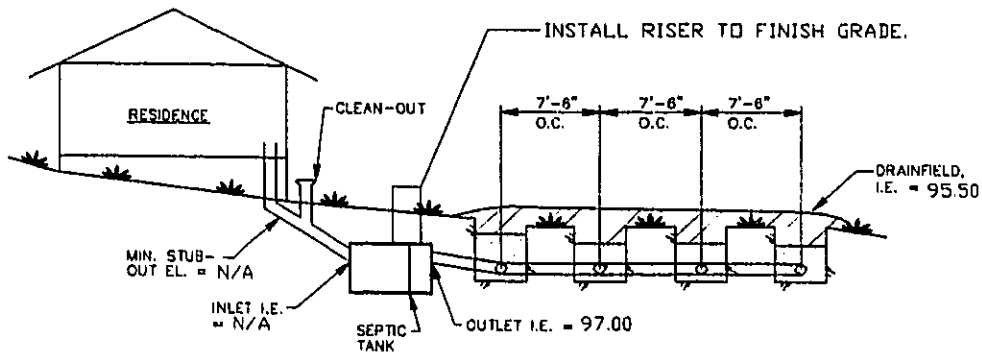

**SEPTIC SYSTEM, CROSS - SECTION**  
NOT TO SCALE

(F)

NOTES:

1. All materials and workmanship shall be in accordance with the latest regulations and requirements of the Tacoma-Pierce County Health Department.
2. Topography, Benchmark and Stub-out elevations based on assumed data and should not be used for any purpose other than design of the drainfield system.
3. The system is designed for 3 bedroom residence with a maximum daily wastewater flow of 450 gallons per day, at a soil loading rate of 0.60 gallons per square feet per day. Garbage disposal system is not allowed.
4. Install 250' L.F. of 4" PVC perforated pipe in a 36" wide trench in upper 24" of soil. Particular care should be exercised to install the pipe level and follow the contours of terrain.
5. Any deviation or alteration of the house plan or location may require revision of the Building Site Application and must be approved by the designer prior to modification, (call L. S. and E. at 848-6608).
6. No excavation, alteration or removal of soil within the primary and reserve drainfield areas. Encroachment of improvements in the primary and reserve drainfield area may cause the site to be unusable.
7. Divert all down spouts or roof drainage water away from drainfield area.
8. Septic tank to be two compartment (s) and have a minimum capacity of 1,125 gallons. Septic tanks must be watertight and if under a driving surface must meet the Department of Transportation H-20 loading standards.
9. All sewer lines under roadways must be encased in pipe with a crush strength of at least 1,000 pounds.
10. If sewer lines and water lines cross, the water line must be at least 18" above the sewer line and encroach in another pipe for a minimum of 10'-0" from the center of the water line. If the waterline is between 5'-0" and 10'-0" from the sewer line, the water line must be encased in pipe. additional fee will be charged.
11. The contractor/ installer shall be responsible to schedule the stub-out inspection prior to release of sewage system permit. If plumbing stub-out is not clearly marked, an additional inspection may be required, and an additional fee will be charged.
12. Final and As-Built inspections, please contact L. S. and E. at 848-6608. If a second inspection is required for improper installation, the installer will be billed for reinspection. Payment must be received prior to acceptance of the system.
13. Proper operation and maintenance must be carried out by the owner, as required by the Health Department.

RECEIVED

MAR 17 2000

Tacoma-Pierce County Health Department



EXPIRES: 4-22-2001

|   |            |                            |
|---|------------|----------------------------|
| Site Address: 15424 110TH AVE. E.   |            | 2<br>3                     |
| Parcel No. 041922-3-014   |            |                            |
| Subdivision: N/A  | Lot N/A    |                            |
| On-Site Sewage Disposal System  |            |                            |
| Client: BOB LUNGBERG  |            |                            |
| Designer: PAUL GREEN  | PE22420    | No. 183                    |
| LeROY SURVEYORS & ENGINEERS, INC.   |            |                            |
| P.O. BOX 740<br>PUYALLUP, WASHINGTON 98372<br>(206) 848-6608 FAX (206) 840-4140 |            |                            |
| Date: 3-15-00   | Scale: N/A | Drawn By: PDH Job No. 5612 |

5

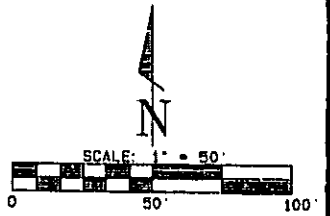

6

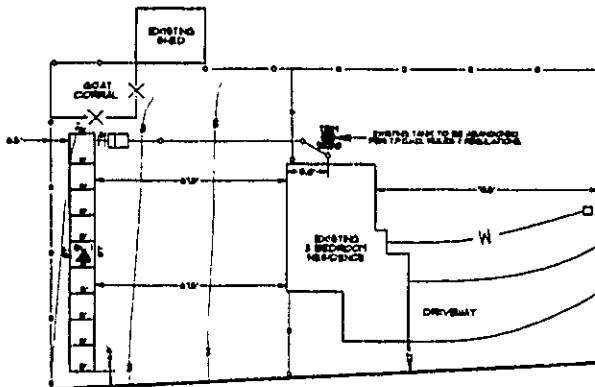

RECEIVED

MAR 17 2000

Tacoma-Pierce County Health Department

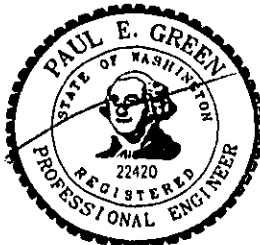

EXPIRES: 4-22-2001

|   |               |               |
|---|---------------|---------------|
| Site Address: 15424 110TH AVE. E.   |               | 3             |
| Parcel No. 041922-3-014   |               | 3             |
| Subdivision: N/A  | Lot N/A       |               |
| <b>On-Site Sewage Disposal System</b>   |               |               |
| Client: BOB LUNGBERG  |               |               |
| Engineer: PAUL GREEN  | PE22420       | No. 183       |
| <b>LeROY SURVEYORS &amp; ENGINEERS, INC.</b>                                    |               |               |
| P.O. BOX 740<br>PUYALLUP, WASHINGTON 98372<br>(206) 848-6608 FAX (206) 840-4140 |               |               |
| Date: 3-15-00   | Scale: 1"=50' | Drawn By: PDH |
|   |               | JOB No 5612   |